

ELECTRONICS

SELECTED for DISTRIBUTION

PWM DRIVERS



EC-PWM-A1-MPC1
Single Proportional Valve



EC-PWM-A2-MPC1
Dual Proportional Valve



EC-PWM-P8-MPC4
Up to 8 Proportional Valves

PRE-PROGRAMMED ECU



EC-MMS-1012-H
5-Function Meter-in System Control



EC-MMS-2218-TILT
Self-levelling System Control



ECOMATIC SYSTEM
3-Function Salt Spreader Control

PROPORTIONAL LEVERS



FTC
Potentiometric



FTH
Hall Effect / 0-5V



JLP
Potentiometric

PROPORTIONAL ROLLERS



FPR
Hall Effect / 0-5V



FPR-PWM
Hall Effect / Dual Valve PWM Driver



DELTA POWER COMPANY
4484 Boeing Drive Rockford, IL 61109 - USA
Phone +1 (815) 397-6628
Fax +1 (815) 397-2526
www.delta-power.com



TECNORD SRL
Via Malavolti, 36 - 41122 Modena - Italy
Tel. +39 (059) 254895
Fax +39 (059) 253512
www.tecnord.com

ELECTRONICS

SELECTED for DISTRIBUTION

HEAVY DUTY MULTI-AXIS JOYSTICKS

JOYSTICK BASE TYPE

BASE CONFIGURATION

AXES CONFIGURATION

TYPE OF GRIP

JHM HALL EFFECT TYPE



L2S Single axis, bidirectional

L4C Dual axes, cross movement

L4D Dual axes, all diagonals

ANL Analog signal 0.5>2.5>4.5 VDC
power supply range = 5 VDC ±5%

ANH Analog signal 0.5>2.5>4.5 VDC
power supply range = 8-32 VDC

AVS Center tap output signal with
digital directional signals

PWM Pulse with modulation current
output factory preset or set via PC

MLT adjustable output signal
for closed loop prop. actuators

CAN CANbus version for connection to
CANbus line J1939 protocol

IL Cylindrical knob
IC Cylindrical



IE Multi-function
ergonomic

- 1 Proportional Roller
- up to 4 Push Buttons



JMF POTENTIOMETRIC

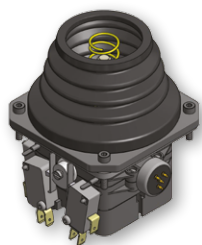

L1SF Single axis, unidirectional
with friction lock

L2S Single axis, bidirectional

L2SF Single axis, bidirectional
with friction lock

L4C Dual axes, cross movement

L4D Dual axes, all diagonals

0 No Pot & switches on Y/X axis

2 Only Bidir. switches on Y/X axis

A Only potentiometer

C Pot & Bidirect. switches

D Only potentiometer

F Pot & Bidirect. switches

G Only potentiometer

I Pot & Bidirect. switches

L Only potentiometer

N Pot & Bidirect. switches

3-pins rotary potentiometer
1 KΩ 25%-75% signal
5 KΩ 5%-95% signal
4-pins rotary potentiometer
10 KΩ 0%-40% signal
5 KΩ 0%-100% signal

MS Ergonomic
symmetric
multi-functions

- up to 3 Proportional Rollers
- up to 10 Push Buttons



MG Ergonomic, right hand,
multi-functions

- up to 2 Proportional Rollers
- up to 9 Push Buttons



HL Ergonomic, left hand,
multi-functions

- up to 2 Proportional Rollers
or 1 Mini-Joystick
- up to 6 Push Buttons



HR Ergonomic, right hand,
multi-functions

- up to 2 Proportional Rollers
or 1 Mini-Joystick
- up to 6 Push Buttons



FLEXIBLE ARMREST LAYOUT

Combining the configuration flexibility of both joystick grip and armrest panel, any machine layout can be easily covered. The special armrest design could include either the EC-MMS-1012 or the EC-MMS-2218, for a compact plug&play solution.

